

**System: Laufschiene eingetütet, für 1 Alu-Rahmentüre bis 25 kg. Design Alu 40/22 mm – Forslide**

System: Top running track groove mounted, for 1 aluminium framed glass door up to 25 kg. Design aluminium 40/22 mm – Forslide

Système: Rail de roulement dans la rainure, pour 1 porte à cadre en alu jusqu'à 25 kg. Design alu 40/22 mm – Forslide

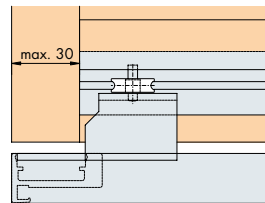
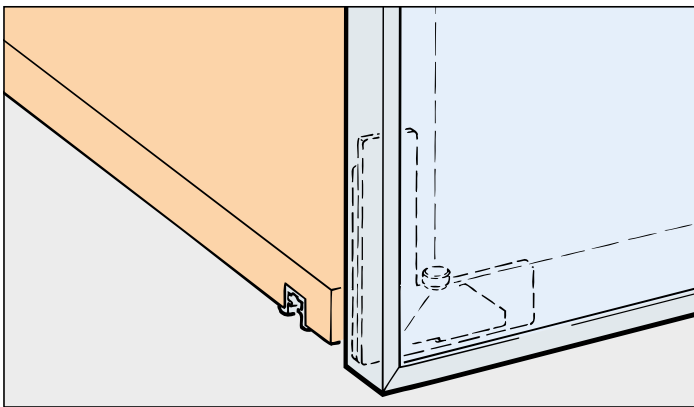

**Einbaubeispiele / Mounting examples / Exemples de montage**

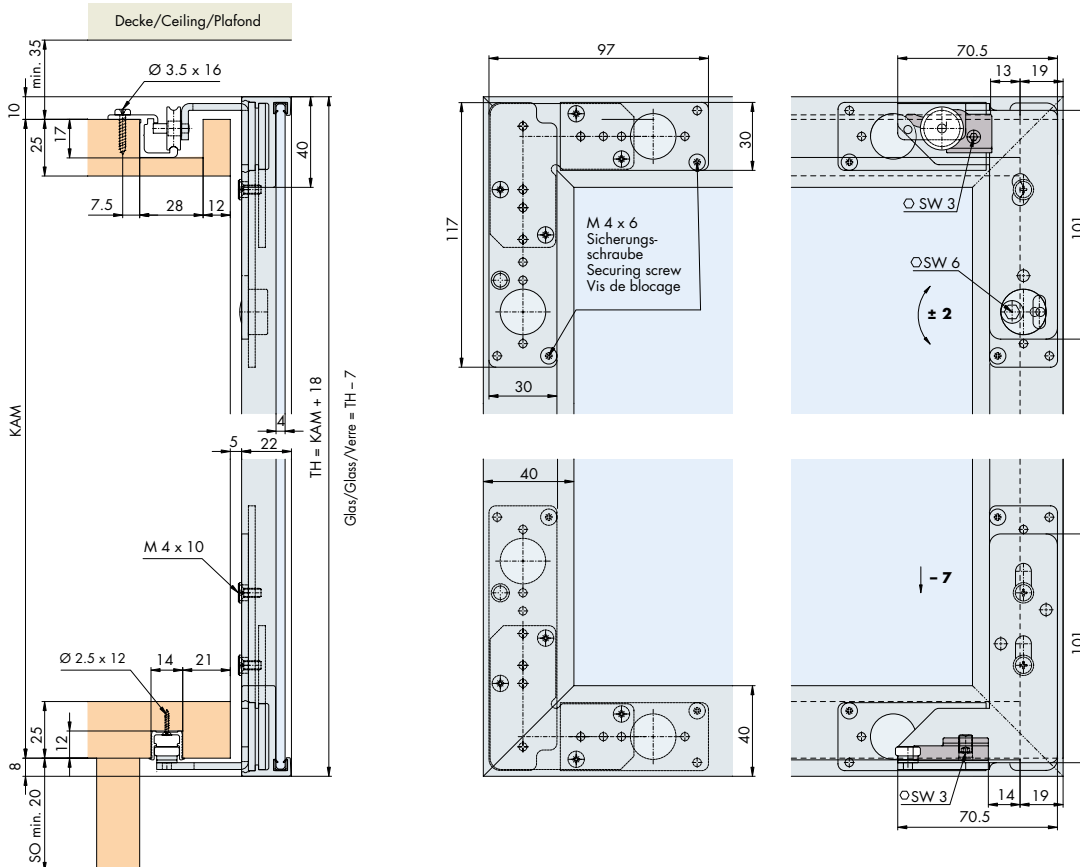

**Glasempfehlung / Glass recommendation / Types de verre recommandés** 

**Einbaubeispiel Zwischenstopper**  
 Mounting example intermediate stop  
 Exemples de montage butée intermédiaire

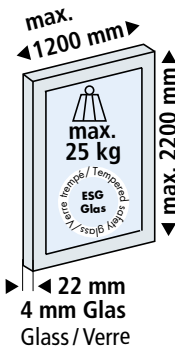
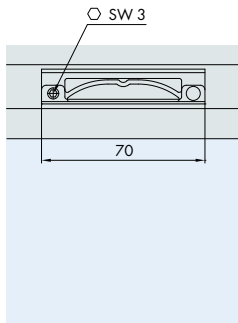

**Türgewichte**  
 Door weights  
 Poids de portes 78

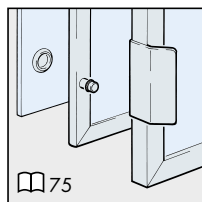

**Garnituren / Sets / Garnitures**

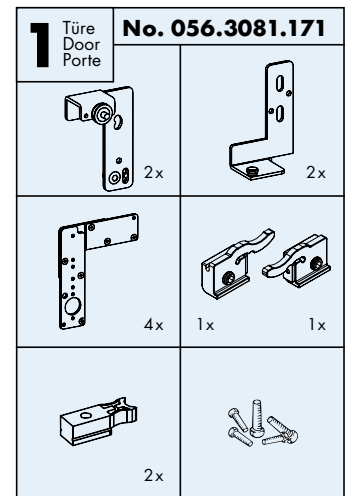

**Zubehör / Accessories / Accessoires**

**Einfachlaufschiene, Alu eloxiert, gelocht**  
 Single top running track, aluminium anodized, pre-drilled  
 Rail de roulement simple, en alu anodisé, perforé

Gr./Size	Art. No./Cat. No.
2500 mm	056.3041.250
3500 mm	056.3041.350
6000 mm	056.3041.600

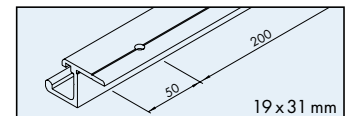

**Einfachführungsschiene, Alu, gelocht**  
 Single guide track, aluminium, pre-drilled  
 Rail de guidage simple, en alu, perforé

2500 mm	056.3079.250
3500 mm	056.3079.350
6000 mm	056.3079.600

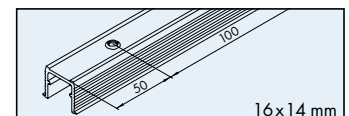

**Glas-Rahmenprofil, Alu eloxiert**  
 Glass frame profile, aluminium anodized  
 Profil de cadre à verre, en alu anodisé

2500 mm	056.3070.250
3500 mm	056.3070.350
6000 mm	056.3070.600



**Dichtungsprofil, Kunststoff grau, für Glas-Rahmenprofil**  
 Sealing profile, plastic grey, for glass frame profile  
 Profil d'étanchéité, en plastique gris, pour profil à cadre en verre

2500 mm	040.3061.250
---------	--------------

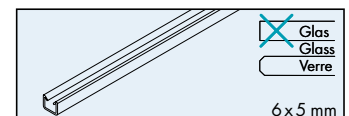

**Zwischenstopper, Kunststoff grau**  
 Intermediate stop, plastic grey  
 Butée intermédiaire, plastique gris

1x	056.3049.071
----	--------------

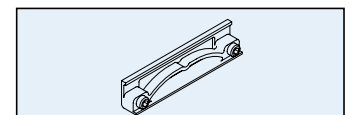

# Sonderzubehör | Special accessories | Accessoires spéciaux

## Zubehör / Accessories / Accessoires

### Sicherheitsclip, Druckguss grau, zu 040.3040

Safety clip, die-cast grey, for 040.3040

Clip de sécurité, moulé sous pression, gris, pour 040.3040

Gr./Size Art. No./Cat. No.

4x 040.3090.051

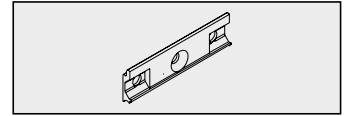

### Befestigungsclip, Kunststoff grau

Fixing clip, plastic grey

Clip de fixation, en plastique gris

18x 040.3084.051

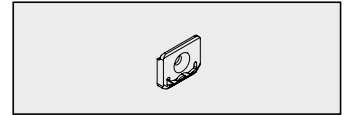

### Befestigungslehre, Kunststoff grau

Fixing jig, plastic grey

Gabarit de fixation, plastique gris

040.3091.001

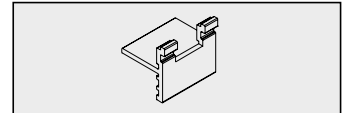

### Frässhablone zur Konfektion der Alu-Rahmentüre, zu Hawa Regal 26 GR, Multiplexplatte

Milling jig for customizing of the aluminium framed door, for Hawa Regal 26 GR, Multiplex panel

Gabarit de fraisage pour la confection de la porte à cadre en alu, pour Hawa Regal 26 GR, plaque multiplex

1x 040.3160.071

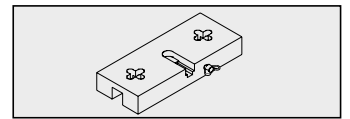

### Klebelehre

Gluing template

Gabarit de collage

Hawa Regal B SP

Hawa Regal B GK

Hawa Regal B GAK

Hawa Regal B GAK/H

1x 040.3020.071

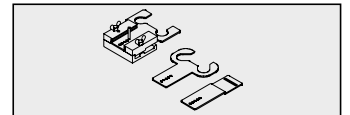

### Klebelehre zu System Hawa Frontal GK

Gluing template for system Hawa Frontal GK

Gabarit de collage pour Hawa Frontal GK

1x 056.3163.071

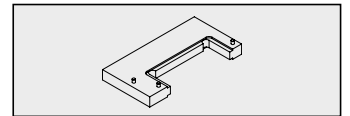

### Klebstoff Ceresit, 3B Silikon, 310 ml

Adhesive Ceresit, 3B silicone, 310 ml

Colle Ceresit, 3B silicone, 310 ml

1x 098.0027.000

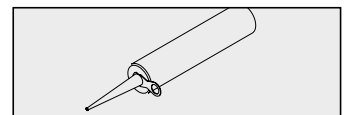

### Penloc GTI, Kleber für Griffe und Glaskappen

Penloc GTI, adhesive for handle and glass cap

Penloc GTI, colle pour poignées et capuchons pour verre

1x 098.0026.000

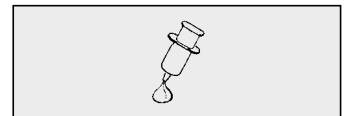

### Schienenreiniger, Kunststoff

Track cleaner, plastic

Nettoyant pour rails, plastique

Hawa Regal A 40

Hawa Regal B 25

Hawa Regal C 16

Hawa Regal C 26

Hawa Creation 25

040.3142.071

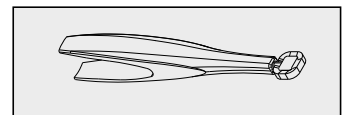

Variante/Option/Variante

## Befestigung mit Verbindungsbolzen

Fixing with connecting bolt

Fixation avec goujon d'assemblage

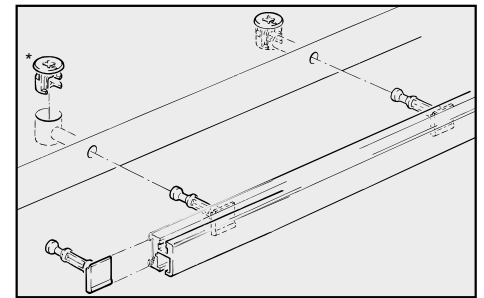
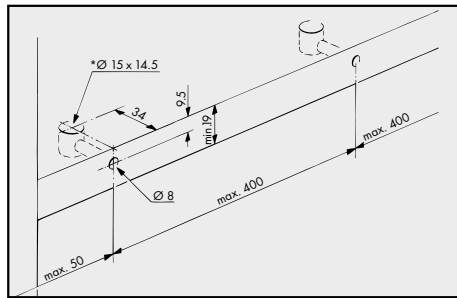

Gr./Size

Art. No./Cat. No.

## Verbindungsbolzen zu MINIFIX 15

Connecting bolt for MINIFIX 15

Goujon d'assemblage pour boîtier MINIFIX 15



1x

053.3111.001

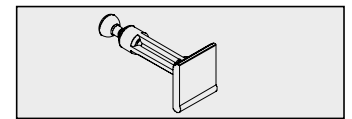

## MINIFIX-Gehäuse mit Abdeckrand, aus Zinkdruckguss vernickelt Ø 15 mm, für Holzdicke 19 mm

MINIFIX housing with rim, zinc die-cast, nickel plated Ø 15 mm, for wood thickness of 19 mm

Boîtier MINIFIX avec bord de recouvrement, en zamac nickelé Ø 15 mm, pour épais. du bois 19 mm



1x

744.0005.001

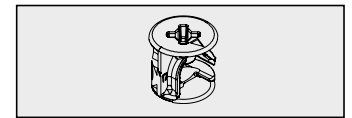

## Griffe/Handles/Poignées

Gr./Size

Art. No./Cat. No.

### Stift-Griff, Alu, natur eloxiert, mit Gummiring schwarz

Knob handle, aluminium, natural colour anodized, with black rubber O-ring

Poignée goupille, en alu anodisé nature, avec bague en caoutchouc noir



2x

053.3101.981



50x

053.3101.982

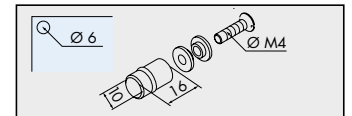

### Griff Kunststoff, mattverchromt, zum Kleben inkl. Klebeband

Handle plastic, chrome plated matt, for glue fixing incl. adhesive tape

Poignée plastique, chromé mât, à coller incl. bande adhésive



2x

053.3323.971

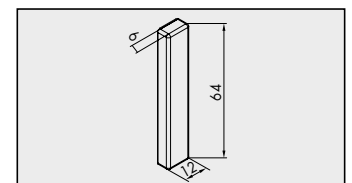

### Muschel-Griff, Alu, natur eloxiert, zum Kleben

Inset handle, aluminium, natural colour anodized, to glue on

Poignée coquille, en alu anodisé nature, à coller



2x

053.3091.982



50x

053.3091.983

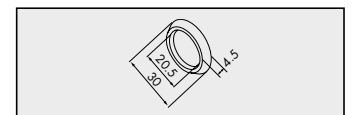

### Muschel-Griff, Alu, natur eloxiert, zum Kleben

Inset handle, aluminium, natural colour anodized, to glue on

Poignée coquille, en alu anodisé nature, à coller



1x

053.3158.901

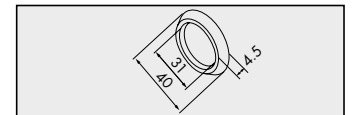

### Leisten-Griff, Alu, natur eloxiert, stirnseitig eingenetet und verklebt

Handle profile, aluminium, natural colour anodized, groove mounted at the front edge and glued on

Baguette poignée, en alu anodisé nature, rainurée dans le chant et collée

2500 mm

056.3028.250

6000 mm

056.3028.600

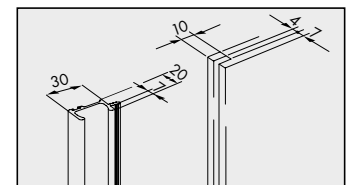

### Griffleiste, Alu eloxiert, gelocht, zum Schrauben, für Holztüren

Handle profile, aluminium anodized, pre-drilled, screwed on, for wooden doors

Poignée-profil, en alu anodisé, perforé, à visser, pour portes en bois

2500 mm

055.3140.250

6000 mm

055.3140.600

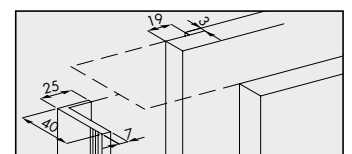

### Penloc GTI, Kleber für Griffe und Glaskappen

Penloc GTI, adhesive for handle and glass caps

Penloc GTI, colle pour poignées et capuchons pour verre



1x

098.0026.000

