

| | Hawa Folding Concept III | Hawa Concept III |
|---|--------------------------|----------------------------|
| DE Masse FR Dimensions EN Dimensions IT Dimensioni ES Medidas | mm | mm |
| BS | | ± 19 |
| S | 18 - 26 | ± 2 |
| T1 | | ± 414 |
| T2 | ± 344 | ± 1' 1 1/2" |
| TB | 440 - 750 | 1' 5 1/8" - 2' 5 1/2" |
| TH | 1200 - 2700 | 3' 11 1/2" - 8' 10 1/8" |
| Z1 | 0 - 6 | 0 - 1/4" |
| Z2 | 0 - 6 | 0 - 1/4" |
| Z3 | 2 - 5 | 3/8" - 3/4" |
| Z5 | 2 - 5 | 3/8" - 3/4" |
| DE Formeln FR Formulas EN Formulas IT Formule ES Fórmulas | mm | mm |
| T1 | | TB + 92 + Z3 - M |
| T2 | TB + 92 + Z3 - M2 | TB - M |
| E1 | | TB - M |
| E2 | TB - M2 | |
| KT1 | | ± T1 |
| KT2 | ± T2 | ± T1 |
| M | | ± S + 3 ± TB - 320 |
| M2 | ± S + 75 ± TB - 390 | ± S + 1/2 ± TB - 1 1/8" |

| | Hawa Folding Concept III | Hawa Concept III |
|---|----------------------------------|----------------------------|
| DE Masse FR Dimensions EN Dimensions IT Dimensioni ES Medidas | Inch | Inch |
| BS | | ± 3/4" |
| S | 3/4" - 1 1/4" | ± 1/8" |
| T1 | | ± 1' 4 3/8" |
| T2 | ± 1' 1 1/8" | |
| TB | 1' 5 1/8" - 2' 5 1/2" | |
| TH | 3' 11 1/2" - 8' 10 1/8" | |
| Z1 | 0 - 1/4" | |
| Z2 | 0 - 1/4" | |
| Z3 | 3/8" - 3/4" | |
| Z5 | 3/8" - 3/4" | |
| DE Formeln FR Formulas EN Formulas IT Formule ES Fórmulas | Inch | Inch |
| T1 | | TB + 3 3/8" + Z3 - M |
| T2 | TB + 3 3/8" + Z3 - M2 | TB - M |
| E1 | | TB - M |
| E2 | TB - M2 | |
| KT1 | | ± T1 |
| KT2 | ± T2 | ± T1 |
| M | | ± S + 1/2 ± TB - 1 1/8" |
| M2 | ± S + 2 3/4" ± TB - 1' 3 1/8" | |

| | EN | IT | ES |
|-----|---|--------------------------------|-------------------------------------|
| BS | Epaisseur du côté extérieur | Spessore lato ferramenta | Grosor del lado del herraje |
| E | Profondeur d'encastrement | Profondità di inserimento | Profundidad de introducción |
| EH | Hauteur d'encastrement | Altezza d'incasso | Altura de montaje |
| KT | Profondeur de corps | Profondità mobile | Profundidad del mueble |
| LMB | Largeur intérieure | Larghezza luce | Ancho interior |
| M | Saillie de la porte par rapport au corps | Sporgenza ante sopra il mobile | Solape de la puerta sobre el cuerpo |
| S | Epaisseur de porte | Spessore ante | Grosor de la puerta |
| T | Profondeur de ferrure | Profondità ferramenta | Profundidad del herraje |
| TA | Ecartement d'axe de la chambrée invisible | Scopanza ante sopra l'asse | Distancia de la cazoleta |
| TB | Largeur de porte | Larghezza ante | Ancho de puerta |
| TH | Hauteur de porte | Altezza ante | Altura de puerta |
| Z | L'utzschienraum | Trallero d'aria | Espacio libre |

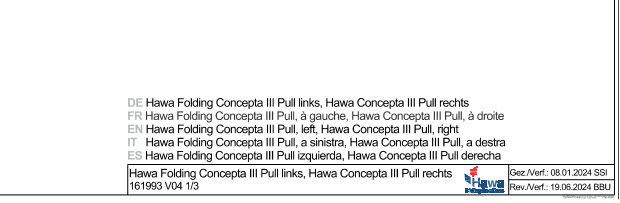
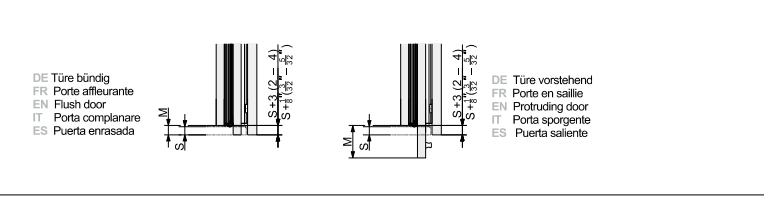
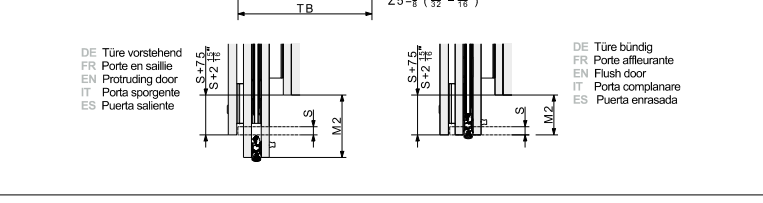

DE Hawa Folding Concept III Pull links, Hawa Concept III Pull rechts
FR Hawa Folding Concept III Pull, à gauche, Hawa Concept III Pull, à droite
EN Hawa Folding Concept III Pull, left, Hawa Concept III Pull, right
IT Hawa Folding Concept III Pull, a sinistra, Hawa Concept III Pull, a destra
ES Hawa Folding Concept III Pull izquierda, Hawa Concept III Pull derecha

Hawa Folding Concept III Pull links, Hawa Concept III Pull rechts
161993 V04 1/3

Doc.Nr.: 08.01.2024 BSU
Rev.Nr.: 10.06.2024 BSU

DE Aussenseite K
FR Face extérieure K
EN Outer face K
IT Lato esterno K
ES Lateral exterior K

DE Beschlagseite H
FR Côte de la ferrure H
EN Fitting side H
IT Lato ferramenta H
ES Lado del herraje H

DE Türe Concepta III 25 Pull
FR Porte Concepta III 25 Pull
EN Door Concepta III 25 Pull
IT Anta Concepta III 25 Pull
ES Puerta Concepta III 25 Pull

DE Türe Concepta III 35 Pull
FR Porte Concepta III 35 Pull
EN Door Concepta III 35 Pull
IT Anta Concepta III 35 Pull
ES Puerta Concepta III 35 Pull

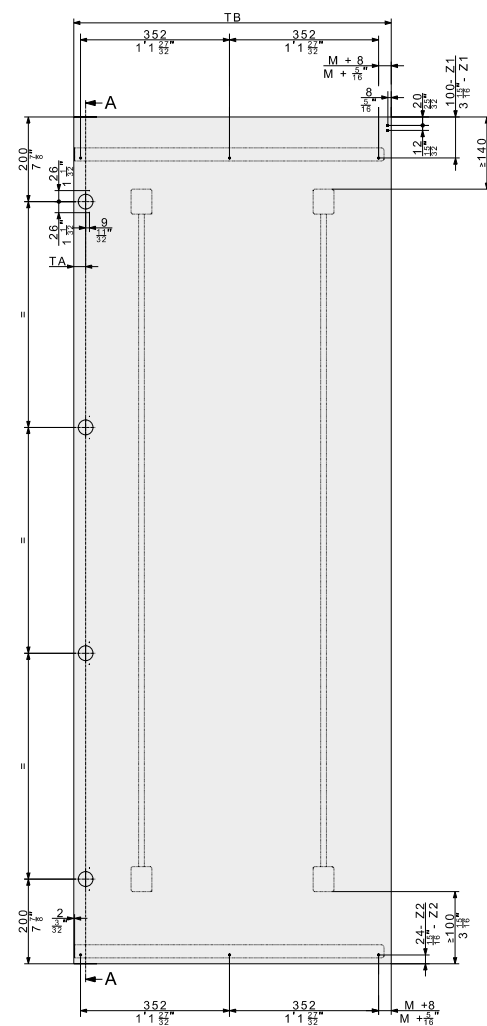
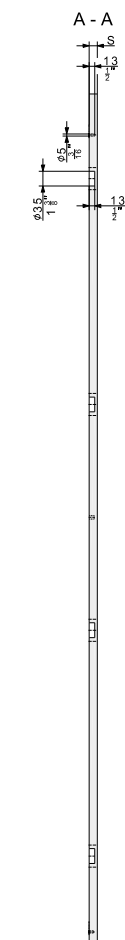
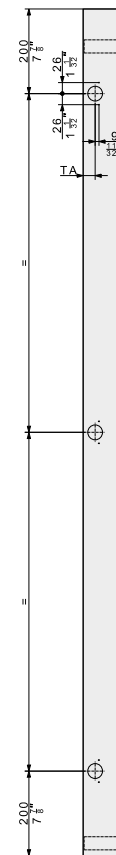
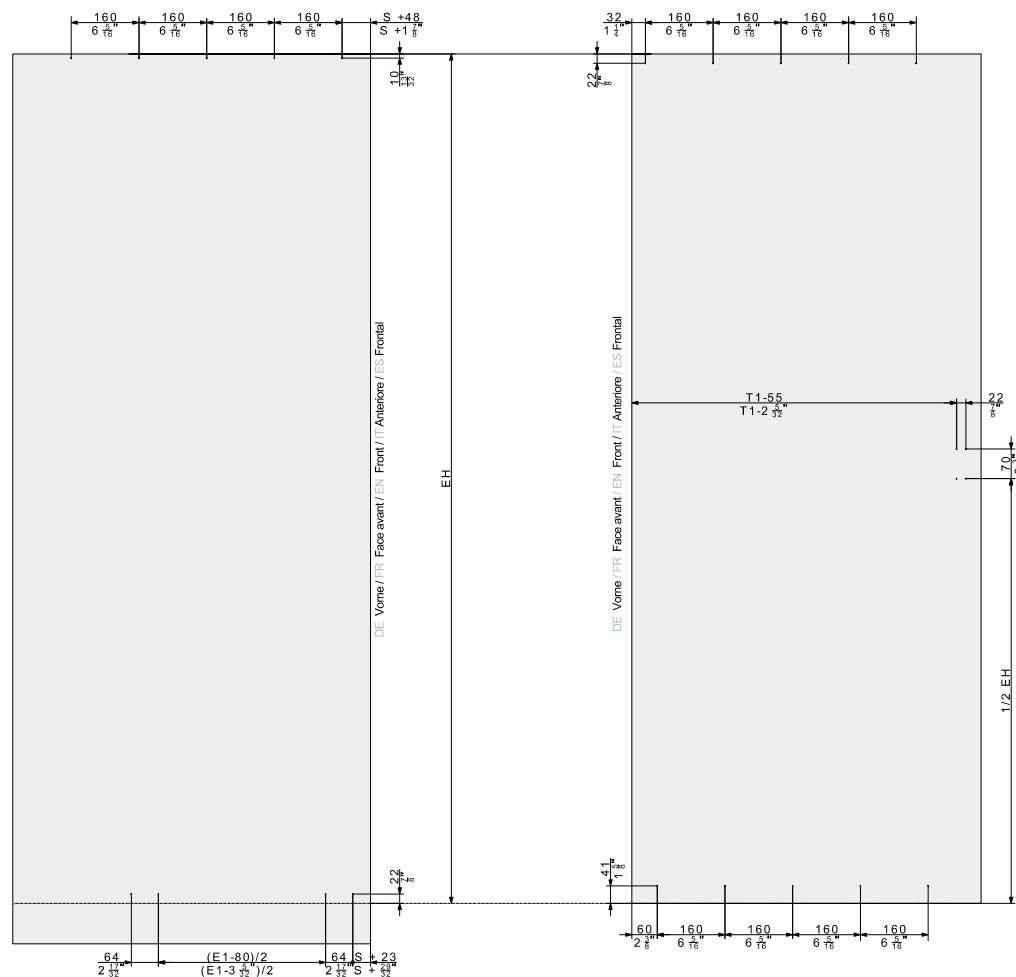

DE Stahlprofil, rechts.
FR Profil en acier, à droite.
EN Steel profile, right.
IT Profilo in acciaio, a destra.
ES Perfil de acero, derecha.

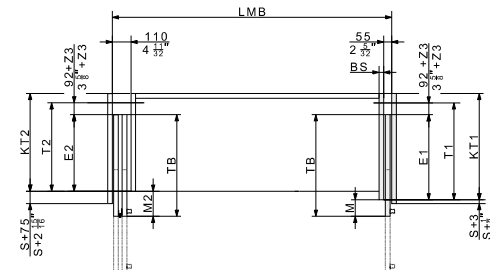
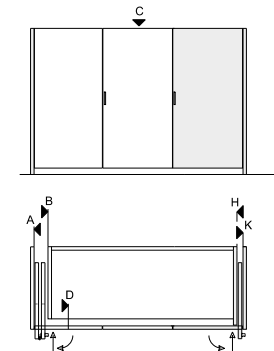
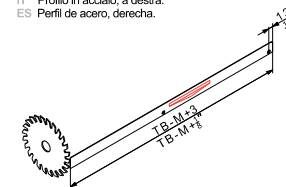

Hawa Concepta III 25 Pull

DE Maximale Gewichte in kg / FR Poids maximale en kg /
EN Maximum weights in kg / IT Pesi massimi in kg /
ES Pesos máximos en kg

DE Türbreite / FR Largeur de porte / EN Door width /
IT Larghezza anta / ES Ancho de puerta

| | 440 | 500 | 550 | 600 | 650 | 700 | 750 |
|------|-----|-----|-----|-----|-----|-----|-----|
| 2200 | 25 | 25 | 25 | 25 | 25 | 25 | 24 |
| 2150 | 25 | 25 | 25 | 25 | 25 | 25 | 23 |
| 2100 | 25 | 25 | 25 | 25 | 25 | 24 | 23 |
| 2050 | 25 | 25 | 25 | 25 | 25 | 24 | 22 |
| 2000 | 25 | 25 | 25 | 25 | 25 | 23 | 21 |
| 1950 | 25 | 25 | 25 | 25 | 24 | 22 | 21 |
| 1900 | 25 | 25 | 25 | 25 | 23 | 21 | 20 |
| 1850 | 25 | 25 | 25 | 24 | 22 | 21 | 19 |
| 1800 | 25 | 25 | 25 | 23 | 21 | 20 | 19 |
| 1750 | 25 | 25 | 25 | 22 | 21 | 19 | 18 |
| 1700 | 25 | 25 | 24 | 22 | 20 | 19 | 17 |
| 1650 | 25 | 25 | 23 | 21 | 19 | 18 | 17 |
| 1600 | 25 | 24 | 22 | 20 | 18 | 17 | 16 |
| 1550 | 25 | 23 | 21 | 19 | 18 | 16 | 15 |
| 1500 | 24 | 22 | 20 | 18 | 17 | 16 | 15 |
| 1450 | 23 | 21 | 19 | 17 | 16 | 15 | 14 |
| 1400 | 22 | 20 | 18 | 17 | 15 | 14 | 13 |
| 1350 | 21 | 19 | 17 | 16 | 15 | 14 | 13 |
| 1300 | 20 | 18 | 16 | 15 | 14 | 13 | 12 |
| 1250 | 19 | 17 | 15 | 14 | 13 | 12 | 11 |
| 1200 | 18 | 16 | 15 | 13 | 12 | 11 | 11 |

DE Türgewicht in kg / FR Poids de porte en kg /
EN Door weight in kg / IT Peso anta in kg /
ES Peso de puerta en kg

Hawa Concepta III 35 Pull

DE Maximale Gewichte in lbs. / FR Poids maximale en lbs. /
EN Maximum weights in lbs. / IT Pesi massimi in lbs. /
ES Pesos máximos en lbs.

DE Türbreite / FR Largeur de porte / EN Door width /
IT Larghezza anta / ES Ancho de puerta

| | 1'5 5/16" | 1'7 11/16" | 1'9 21/32" | 1'11 9/16" | 2'1 15/16" | 2'3 3/16" | 2'5 17/32" |
|------------|-----------|------------|------------|------------|------------|-----------|------------|
| 7'2 3/8" | 55 | 55 | 55 | 55 | 55 | 55 | 53 |
| 7'0 3/16" | 55 | 55 | 55 | 55 | 55 | 55 | 51 |
| 6'8 23/32" | 55 | 55 | 55 | 55 | 55 | 55 | 51 |
| 6'6 3/4" | 55 | 55 | 55 | 55 | 55 | 55 | 49 |
| 6'4 25/32" | 55 | 55 | 55 | 55 | 55 | 55 | 49 |
| 6'2 13/16" | 55 | 55 | 55 | 55 | 55 | 51 | 46 |
| 6'0 3/8" | 55 | 55 | 55 | 55 | 53 | 49 | 46 |
| 5'10 1/2" | 55 | 55 | 55 | 55 | 51 | 46 | 44 |
| 5'8 29/32" | 55 | 55 | 55 | 55 | 49 | 46 | 42 |
| 5'6 11/16" | 55 | 55 | 53 | 49 | 44 | 42 | 37 |
| 5'4 33/64" | 55 | 55 | 51 | 46 | 42 | 40 | 37 |
| 5'3" | 55 | 53 | 49 | 44 | 40 | 37 | 35 |
| 5'1 1/8" | 55 | 51 | 46 | 42 | 40 | 35 | 33 |
| 4'11 1/8" | 53 | 49 | 44 | 40 | 37 | 35 | 33 |
| 4'9 3/8" | 51 | 46 | 42 | 37 | 35 | 33 | 31 |
| 4'7 1/8" | 49 | 44 | 40 | 37 | 33 | 31 | 29 |
| 4'5 5/8" | 46 | 42 | 37 | 35 | 33 | 31 | 29 |
| 4'3 3/8" | 44 | 40 | 35 | 33 | 31 | 29 | 26 |
| 4'1 7/32" | 42 | 37 | 33 | 31 | 29 | 26 | 24 |
| 3'11 1/4" | 40 | 35 | 33 | 29 | 26 | 24 | 24 |

DE Türgewicht in lbs. / FR Poids de porte en lbs. /
EN Door weight in lbs. / IT Peso anta in lbs. /
ES Peso de puerta en lbs.

Hawa Concepta III 35 Pull

DE Maximale Gewichte in kg / FR Poids maximale en kg /
EN Maximum weights in kg / IT Pesi massimi in kg /
ES Pesos máximos en kg

DE Türbreite / FR Largeur de porte / EN Door width /
IT Larghezza anta / ES Ancho de puerta

| | 440 | 500 | 550 | 600 | 650 | 700 | 750 |
|------|-----|-----|-----|-----|-----|-----|-----|
| 2700 | 35 | 35 | 35 | 35 | 35 | 35 | 35 |
| 2650 | 35 | 35 | 35 | 35 | 35 | 35 | 35 |
| 2600 | 35 | 35 | 35 | 35 | 35 | 35 | 35 |
| 2550 | 35 | 35 | 35 | 35 | 35 | 35 | 35 |
| 2500 | 35 | 35 | 35 | 35 | 35 | 35 | 35 |
| 2450 | 35 | 35 | 35 | 35 | 35 | 35 | 34 |
| 2400 | 35 | 35 | 35 | 35 | 35 | 35 | 33 |
| 2350 | 35 | 35 | 35 | 35 | 35 | 34 | 32 |
| 2300 | 35 | 35 | 35 | 35 | 35 | 34 | 31 |
| 2250 | 35 | 35 | 35 | 35 | 35 | 33 | 31 |
| 2200 | 35 | 35 | 35 | 35 | 34 | 32 | 30 |
| 2150 | 35 | 35 | 35 | 35 | 33 | 31 | 29 |
| 2100 | 35 | 35 | 35 | 35 | 32 | 30 | 28 |
| 2050 | 35 | 35 | 35 | 34 | 31 | 29 | 27 |
| 2000 | 35 | 35 | 35 | 33 | 30 | 28 | 26 |
| 1950 | 35 | 35 | 35 | 32 | 29 | 27 | 26 |
| 1900 | 35 | 35 | 34 | 31 | 29 | 27 | 25 |

DE Türgewicht in kg / FR Poids de porte en kg /
EN Door weight in kg / IT Peso anta in kg /
ES Peso de puerta en kg

Hawa Concepta III 35 Pull

DE Maximale Gewichte in lbs. / FR Poids maximale en lbs. /
EN Maximum weights in lbs. / IT Pesi massimi in lbs. /
ES Pesos máximos en lbs.

DE Türbreite / FR Largeur de porte / EN Door width /
IT Larghezza anta / ES Ancho de puerta

| | 1'5 5/16" | 1'7 11/16" | 1'9 21/32" | 1'11 9/16" | 2'1 15/16" | 2'3 3/16" | 2'5 17/32" |
|-------------|-----------|------------|------------|------------|------------|-----------|------------|
| 8'10 3/8" | 77 | 77 | 77 | 77 | 77 | 77 | 77 |
| 8'8 11/16" | 77 | 77 | 77 | 77 | 77 | 77 | 77 |
| 8'6 3/4" | 77 | 77 | 77 | 77 | 77 | 77 | 77 |
| 8'4 25/32" | 77 | 77 | 77 | 77 | 77 | 77 | 77 |
| 8'2 13/16" | 77 | 77 | 77 | 77 | 77 | 77 | 77 |
| 8'0 3/8" | 77 | 77 | 77 | 77 | 77 | 77 | 75 |
| 7'10 1/4" | 77 | 77 | 77 | 77 | 77 | 77 | 73 |
| 7'8 1/8" | 77 | 77 | 77 | 77 | 77 | 77 | 71 |
| 7'6 5/16" | 77 | 77 | 77 | 77 | 77 | 77 | 68 |
| 7'4 3/8" | 77 | 77 | 77 | 77 | 77 | 77 | 68 |
| 7'2 1/8" | 77 | 77 | 77 | 77 | 77 | 75 | 66 |
| 7'0 3/8" | 77 | 77 | 77 | 77 | 77 | 73 | 64 |
| 6'10 13/16" | 77 | 77 | 77 | 77 | 77 | 71 | 62 |
| 6'8 23/32" | 77 | 77 | 77 | 77 | 75 | 68 | 64 |
| 6'6 3/4" | 77 | 77 | 77 | 75 | 68 | 64 | 60 |
| 6'4 25/32" | 77 | 77 | 77 | 73 | 66 | 62 | 57 |
| 6'2 13/16" | 77 | 77 | 77 | 71 | 64 | 60 | 57 |
| 6'0 3/8" | 77 | 77 | 75 | 68 | 64 | 60 | 55 |

DE Türgewicht in lbs. / FR Poids de porte en lbs. /
EN Door weight in lbs. / IT Peso anta in lbs. /
ES Peso de puerta en lbs.

DE Abkürzungen / FR Abréviations / EN Abbreviations / IT Abbreviazioni / ES Abreviaturas

| DE | FR | EN | IT | ES | |
|-----|--------------------------|---|---|--------------------------------|-------------------------------------|
| BS | Beschlagstärkdicke | Epaisseur du côté extérieur | Fitting side thickness | Spessore lato ferramenta | Grosor del lado del herraje |
| E | Einschubtiefe | Profondeur d'encastrement | Slide-in depth | Profondità di inserimento | Profundidad de introducción |
| EH | Einbauhöhe | Hauteur d'encastrement | Installation height | Altezza d'incasso | Altura de montaje |
| KT | Korpusstiefe | Profondeur de corps | Cabinet depth | Profondità mobile | Profundidad del mueble |
| LMB | Lichtmassbreite | Largeur intérieure | Inside clearance | Larghezza luce | Ancho interior |
| M | Türüberstand über Korpus | Saillie de la porte par rapport au corps | Door projection over cabinet | Sporgenza anta sopra il mobile | Solape de la puerta sobre el cuerpo |
| S | Türdicke | Epaisseur de porte | Door thickness | Spessore anta | Grosor de la puerta |
| T | Beschlagtiefe | Profondeur de ferrure | Hardware depth | Profondità ferramenta | Profundidad del herraje |
| TA | Topfachsabstand | Ecartement d'axe de la chambrée invisible | Axis-centre distance of concealed hinge | Distanza scatola asse | Distancia de la cazoleta |
| TB | Türbreite | Largeur de porte | Door width | Larghezza anta | Ancho de puerta |
| TH | Türhöhe | Hauteur de porte | Door height | Altezza anta | Altura de puerta |
| Z | Luftzwischenraum | Ueu dans l'espace | Air gap | Traffero d'aria | Espacio libre |

DE Hawa Folding Concepta III Pull links, Hawa Concepta III Pull rechts
FR Hawa Folding Concepta III Pull, à gauche, Hawa Concepta III Pull, à droite
EN Hawa Folding Concepta III Pull, left, Hawa Concepta III Pull, right
IT Hawa Folding Concepta III Pull, a sinistra, Hawa Concepta III Pull, a destra
ES Hawa Folding Concepta III Pull izquierda, Hawa Concepta III Pull derecha
Hawa Vöding Concepta III Pull links, Hawa Concepta III Pull rechts
161993 V04 3/3